

Instruction Manual

CORDLESS ELECTRIC MOP (ADVANCED VERSION)

(super long battery life / no residual water marks)

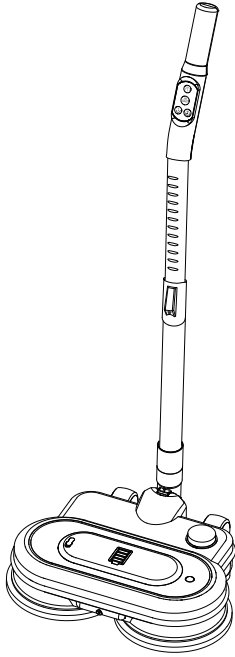

1. Use

To complete mopping work simply and efficiently.

2. Product features

1. Dual spin mops (each with one separate motor) design - easier to clean dirty floors than traditional roller kind or dual spin mops with a shared motor
2. Efficient transmission - The umbrella-shaped gear transmission structure is twice as efficient as the general worm gear transmission.
3. Two-speeds - high speed to remove heavy dirt, low speed to save power
4. Cordless operation - easy to move around
5. Detachable rechargeable battery (can be removed for charging; can be replaced if damaged)
6. Installed with anti-collision strips - to avoid damage to furniture
7. Mist water spray - more even.
8. Condenser lens spot light design - no dirt can escape
9. No residual water marks after mopping - installed with a long mop at the rear edge to wipe away residual water marks
10. Double rear wheel design - making the mop easier to move and store
11. The length of the tow bar is adjustable
12. Automatic shutdown - when the control handle is stowed (locked into the main head), the machine automatically shuts down

3. Technical parameters

Model NO.	HE-409
Power Supply	For control handle: 1.5V AAA battery x 2; For main unit: 22.2V(3.7V cell x 6) 2000mAh rechargeable lithium ion power battery (detachable for charging)
Rated Power	45W
Motor	2 units
Transmission	bevel gear
Charging time	2~3 hours
Usage time	around 90 min.
Water Tank Capacity	250ml

4. Parts & accessories description

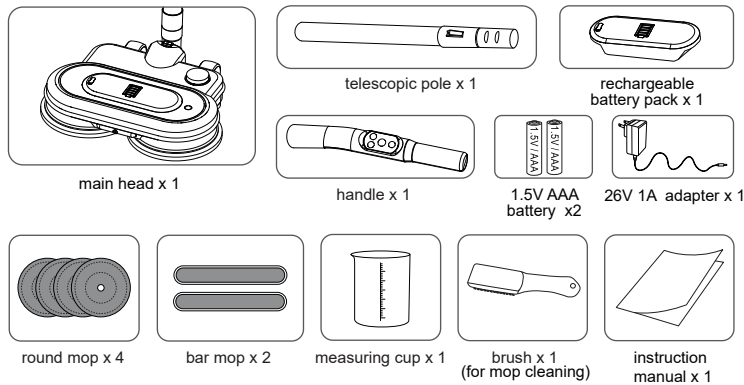

5. Appearance and function description

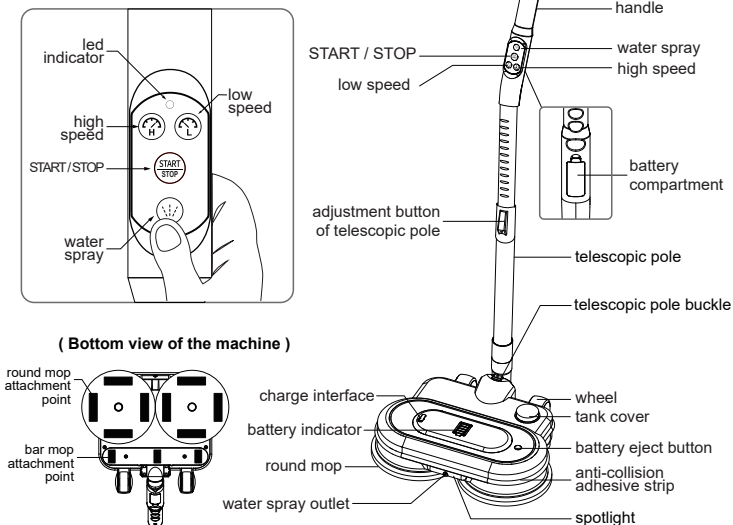

6. Product assembly steps

Step.1

Correctly install the battery (AAAx2) into the handle battery compartment as shown in the diagram.

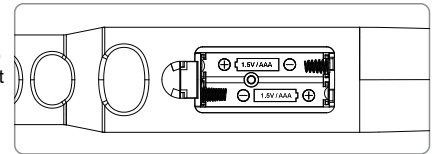

Step.2

1. Insert the telescopic pole into the main head
2. Insert the handle into the telescopic pole

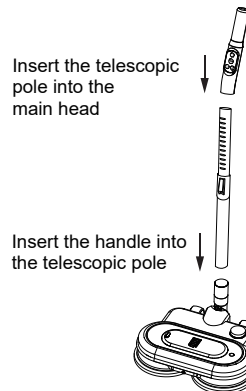

Step.3

1. Insert the left end of the rechargeable battery pack into the main head, as shown in the diagram
2. Press down the other end

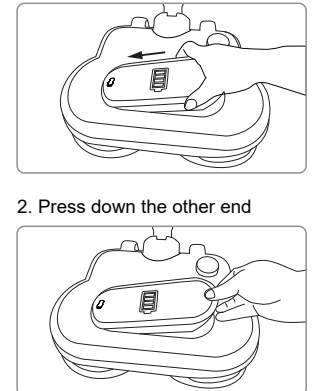

Step.4

Install mops:

Align the mop with the center of the turntable on the bottom of the main head and press down to make the Velcro and mop stick firmly.

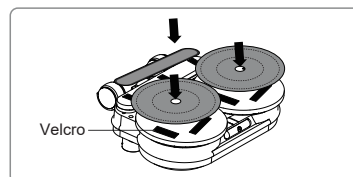

Step5

Add water:

Fill the measuring cup with 250ml of water or floor cleaning solution, align it with the water inlet and slowly pour it in.

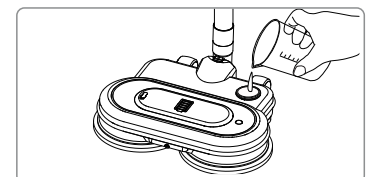

7. How to use the product

Step.1

To turn on the power:

Press the main head with one foot and pull the control handle away from the main head then the power is turned on.

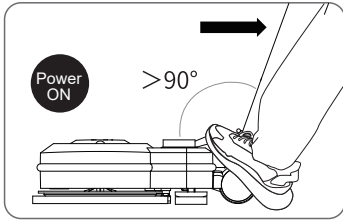

Step.2

Adjust the length of the telescopic pole:

Push up the telescopic pole adjustment button to adjust the length

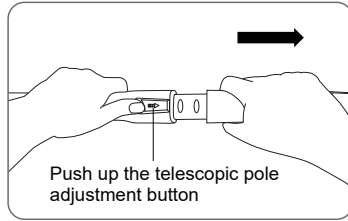

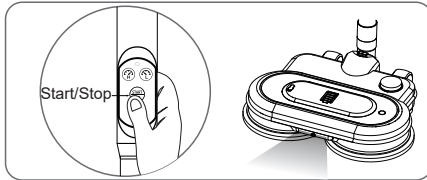

Step.3

1. Control the main head:
Press the Start/Stop button  on the control handle, the front light of the main head will be lit up, and the speed is preset to "high speed"

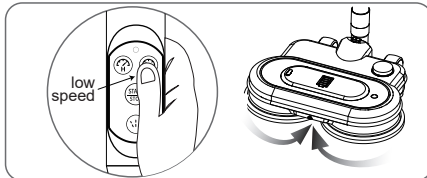

2. Adjust the speed
Press the low speed button  to switch to low speed rotation; press the high speed button again to switch back to high speed rotation.



3. Spraying water
Each press of the water spray button , water will be sprayed once, 0.5 second each time.

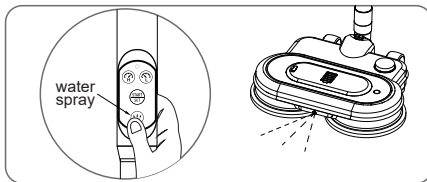

9. Low battery indicator

When the battery level is lower than 10%, the first battery indicator light turns red and flashes. At this time, it should be charged immediately.

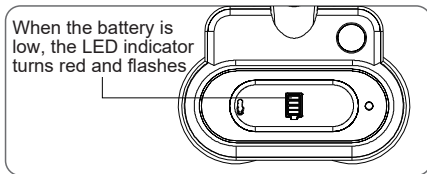

10. How to charge

Connect a power supply to charge directly, or remove the battery box to charge.

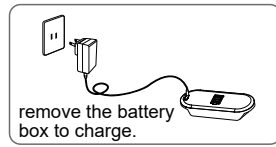
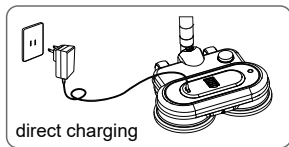

LED indicator light shows status during charging

- A: When the charge level is <25%, the 1st LED indicator light flashes blue.
 B: When the charge level is between 25% and 50%, the 2nd LED indicator flashes blue.
 C: When the charge level is between 50% and 75%, the 3rd LED indicator flashes blue.
 D: When the charge level is between 75% and 99%, the 4th LED indicator flashes blue.
 E: When is fully charged, the whole LED indicator lights will be on.

11. Precautions for mop cleaning cleaning method

After removing the mop, rinse it with clean water once, and then clean it with soap solution or cleaning agent.

Notes:

1. After cleaning, it must be air dried
2. Before using the mop, please confirm that there are no hard objects sticking to the mop.
3. If there are hard objects or glue on the mop that cannot be removed, please replace it with a new mop.

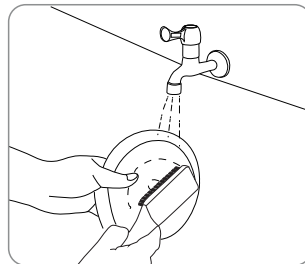

8. Storage steps

Step.1

Press the main head with one foot and push the control handle back to the main unit to turn it off.

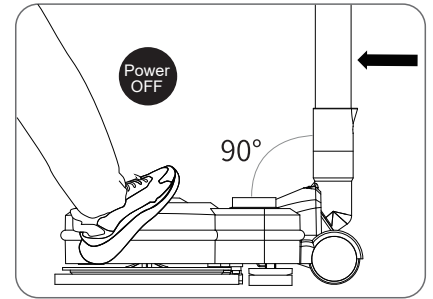

Step.2

Lay down the whole unit and remove the round and bar mops

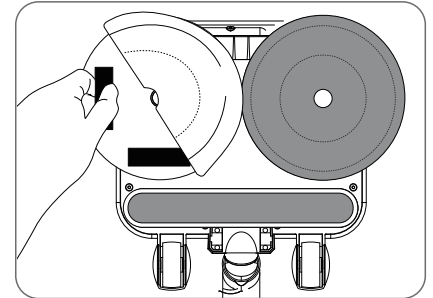

Step.3

Wheel to storage

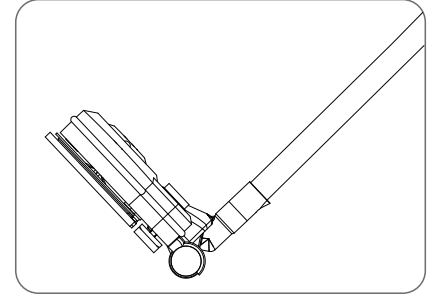

12. Precautions for using rechargeable battery pack

1. Do not use the battery pack when it is swollen, otherwise it may explode or burn, and please contact seller immediately.
2. Please use the charging adapter included with the product to charge the battery pack. If you use a substitute, there may be no charging or short circuit.
3. Do not place the product near ignition sources or flammable and explosive materials.
4. Please store the product in a cool and dry place.
5. Do not disassemble, squeeze or drop the battery pack.
6. Make sure the machine is powered off before removing the battery.
7. Please refer to the manufacturer's instructions for correct charging.
8. When the machine might not be used for a long time, in order to ensure the best performance of the battery, the battery pack needs to be charged and discharged once a month.
9. The battery pack performs best when started at room temperature.

13. Troubleshooting methods

Phenomenon of failure	Possible causes	Handling method
Unable to start	<ol style="list-style-type: none"> 1. Low battery 2. The power switch is not turned on 3. Check the battery power at both the handle and the main head 4. Excessive use leads to motor suspension 	<ol style="list-style-type: none"> 1. Charging 2. Turn on the power switch 3. Replace the handle battery or charge the main head battery 4. After cooling, restart for use
There are many water marks on the ground	Mop too wet	Wring out excessive moisture on the mop
Serious shaking of machine body during dragging	Mop not properly installed	Install the mop correctly
Making strange noises when mopping the floor	There may be foreign matter on the base rotating disc	Remove foreign objects from the surface of the base rotating disc

(Note: Do not disassemble the machine by yourself, and contact professionals or suppliers in time in case of failure.)